



Axial-Restraint Pipe Coupling

STRAUB-GRIP-L COUPLING



For IPS Outside Diameter Pipe

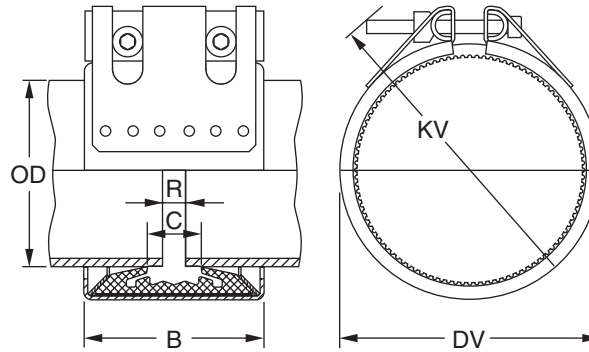

3/4" - 2" couplings with 1 Bolt only.

STRAUB-GRIP L

Nominal IPS Inches	PIPE OUTSIDE DIAMETER		Working Pressure psi/bar	Agency Approved Pressure* psi/bar	COUPLING DIMENSIONS		ASSEMBLED DIMENSIONS		MAXIMUM DISTANCE BETWEEN PIPE ENDS (Rmax.)		Torque Rate Ft.lbs./Nm	Approx. Weight Each Lbs./kg
	Actual In./mm	OD Range In./mm			B	C	DV	KV	Without Strip insert In./mm	With Strip insert In./mm		
3/4	1.050 26.9	1.04 - 1.08 26.4 - 27.4	670 46	232 16.0	1.8 46	0.7 18	1.7 43	2.8 71	0.2 5	0.4 10	0.4 0.2	
1	1.315 33.7	1.31 - 1.35 33.2 - 34.2	550 38	232 16.0	1.8 46	0.7 18	2 51	3 76	0.2 5	0.4 10	0.4 0.2	
1 1/4	1.660 42.4	1.65 - 1.69 41.9 - 42.9	400 30	232 16.0	2.4 61	1 25	2.4 61	3.7 94	0.2 5	0.4 10	0.8 0.4	
1 1/2	1.900 48.3	1.88 - 1.92 47.7 - 48.7	440 30	232 16.0	2.4 61	1 25	2.6 66	3.9 99	0.2 5	0.4 10	0.9 0.4	
2	2.375 60.3	2.35 - 2.40 59.6 - 60.9	320 22	232 16.0	3 76	1.5 38	3.1 79	4.3 109	0.4 10	0.6 15	1.2 0.5	
2 1/2	2.875 73.0	2.85 - 2.90 72.3 - 73.6	450 31	232 16.0	3.7 94	1.6 41	3.9 99	5.3 135	0.4 10	0.6 15	2.7 1.2	
3	3.500 88.9	3.46 - 3.54 87.8 - 89.9	450 31	232 16.0	3.7 94	1.6 41	4.4 112	5.9 150	0.4 10	1.0 25	2.6 1.2	
3 1/2	4.000 101.6	3.96 - 4.04 100.5 - 102.6	320 22	232 16.0	3.7 94	1.4 36	5.1 130	6.3 160	0.6 15	0.6 15	3.3 1.5	
4	4.500 114.3	4.46 - 4.54 113.2 - 115.3	232 16	232 16.0	3.7 94	1.6 41	5.4 137	6.7 170	0.4 10	1 25	3.2 1.5	
5	5.500 139.7	5.51 - 5.62 139.9 - 142.7	232 16	232 16.0	4.3 109	2.1 53	6.5 165	8.3 211	0.4 10	1.4 36	5.7 2.6	
6	6.625 168.3	6.56 - 6.69 166.6 - 169.9	232 16	188 13.0	4.3 109	2.1 53	7.6 193	9.1 231	0.4 10	1.4 36	6.4 2.9	
8	8.625 219.1	8.54 - 8.71 216.9 - 221.2	232 16	145 10.0	5.6 142	3.1 79	9.8 249	11.6 295	0.4 10	1.4 36	13.0 5.9	
10	10.750 273.0	10.65 - 10.85 270.5 - 275.5	100 7	67 4.6	5.5 140	3.1 79	11.9 302	13 330	0.4 10	1.4 36	12.7 5.8	
12	12.750 323.9	12.62 - 12.87 320.5 - 326.8	70 5	52 3.6	5.5 140	3.1 79	13.9 353	15 381	0.4 10	1.4 36	14.3 6.5	
14	14.000 355.6	13.86 - 14.13 352.0 - 358.9	60 4	45 3.1	5.5 140	3.1 79	15.2 386	16.3 414	0.4 10	1.4 36	15.4 7.0	
16	16.000 406.4	15.85 - 16.16 402.5 - 410.4	45 3	35 2.4	5.5 140	3.1 79	17.1 434	18.3 465	0.4 10	1.4 36	16.9 7.7	
18	18.000 457.2	17.81 - 18.17 452.3 - 461.5	30 2.0	30 2.0	5.5 140	3.1 79	19.2 488	20.5 521	0.4 10	1.4 36	18.5 8.4	
20	20.000 508.0	19.82 - 20.18 503.4 - 512.5	30 2.0	30 2.0	5.5 140	3.1 79	21.2 538	22.4 569	0.4 10	1.4 36	20.2 9.2	
22	22.000 558.8	21.83 - 22.19 554.4 - 563.6	30 2.0	30 2.0	5.5 140	3.1 79	23.2 589	24.4 620	0.4 10	1.4 36	21.8 21.8	
24	24.000 609.6	23.82 - 24.17 605.0 - 613.9	15 1.0	15 1.0	5.5 140	3.1 79	25.2 640	26.4 671	0.4 10	1.4 36	23.3 10.6	

See label on coupling for proper torque rates

*Agency approved pressures are for applications that require authorization of Classification Societies, such as Marine Approval Bodies.

Other sizes available upon request.

3/4" - 8": W5 only
10" - 24": W2 or W5



All STRAUB couplings require the correct use of a torque wrench for a safe and proper installation. STRAUB couplings must be torqued to the specified value as printed on each individual coupling. Failure to do so can result in injury or death.